

V391 BREAKDOWN

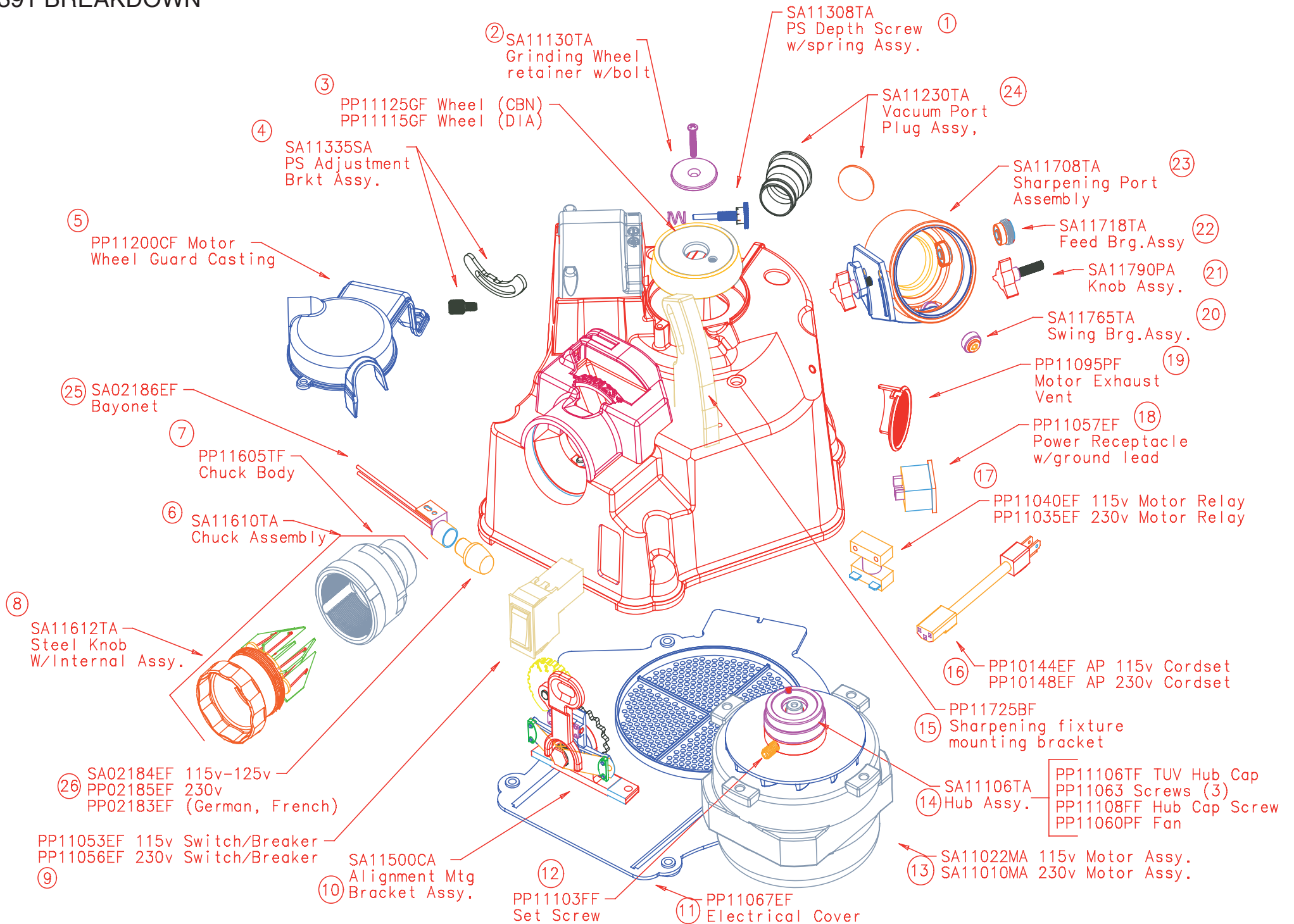

V391 BREAKDOWN
PARTS LIST

1		SA11308TA	PS ADJ DEPTH SCREW/SPRING
2		SA11130TA	GRINDING WHEEL RETAINER W/BOLT
3		PP11115GF	V-ANGLE WHEEL - DIAMOND 180
3		PP11125GF	V-ANGLE WHEEL - CBN 180
4		SA11335SA	PS ADJT BRKT W SCREW (V390)
5		PP11200CF	WHEEL GUARD CASTING
6		SA11610TA	V-390 1/8-3/4 CHUCK W/SLOT
7		PP11605TF	CHUCK BODY V-390 WITH PIN
8		SA11612TA	STEEL CHUCK KNOB ASSEMBLY
9		PP11053EF	115V SWITCH/BREAKER
9		PP11056EF	230V SWITCH/BREAKER
10		SA11500CA	VT ALIGNMENT MTG BRACKET ASSM.
11		PP11067EF	ELECT. BOTTOM COVER W/SLOT
12		PP11103FF	5/16-18X5/8 1/2 DOG PT. SET SCREW
13		SA11010MA	220V. MOTOR ASSEMBLY
13		SA11022MA	115V. MOTOR ASSEMBLY (REV A)
14		SA11106TA	HUB ASSEMBLY
15		PP11725BF	SHARPENING FIXT MTG BRKT /PIN ALIGN
16		PP10144EF	AP 115V CORDSET
16		PP10148EF	AP 230V CORDSET
17		PP11035EF	230V MOTOR RELAY
17		PP11040EF	115V MOTOR RELAY
18		PP11057EF	POWER RECEPTACLE W/GROUND LEAD
19		PP11095PF	MOTOR EXHAUST VENT
20		SA11765TA	SWING CAM BEARING BOLT/BUSH ASSM.
21		SA11790PA	POINT ANGLE LOCK ASSEMBLY
22		SA11718TA	FEED CAM BOLT ASSM.
23		SA11708TA	SHARPENING PORT ASSM
24		SA11230TA	VACUUM TUBE/ PORT PLUG
25		SA02186EA	ALIGNMENT LAMP SOCKET & SCREW
26		PP02183EF	230V GERMANY ALIGN LAMP
26		PP02185EF	230V ALIGNMENT LAMP
26		SA02184EA	115V ALIGNMENT LAMPS (2)
NOT SHOWN		SA11638TA	V-390 1/8-3/4 MORSE TAPER CHUCK
NOT SHOWN		PP11852KF	ENGLISH V-390 INSTRUCTION MANUAL
NOT SHOWN		PP11858KF	ENGLISH V-391 INSTRUCTION MANUAL